

# M-series

for single phase alternating current, 2 pole

RH22M-2E



## Description

Motor technology: AC  
 Rated voltage  $U_N$ : 1~ 230 V $\pm$ 10 %\*  
 Rated frequency  $f_N$ : 50 Hz\*  
 Motor input power  $P_1$ : 0.16 kW\*  
 Rated current  $I_N$ : 0.68 A\*  
 Rated speed  $n_N$ : 2750 min<sup>-1</sup>\*  
 Current increase  $\Delta I$ : 35 %  
 Service capacitor  $C_{400V}$ : 7.0  $\mu$ F  
 Dynamic pressure:  $p_{d2} = 1.45 \cdot 10^{-5} \cdot q_v^2$  [Pa]  
 Thermal class: **THCL155**\*  
 Min. permitted ambient temperature  $t_{R(min)}$ : -25 °C  
 Max. permitted ambient temperature  $t_{R(max)}$ : 60 °C  
 Protection class: IP44  
 Motor protection: Thermal contact  
 Impeller : Aluminium, uncoated  
 Motor: 1 coat paint, pebble grey  
 Conformity: ErP 2013, CE  
**ErP-Daten**  
 Efficiency  $\eta_{statA}$ : 39.6 %  
 Efficiency:  $N_{actual} = 58.6 / N_{target} = 58$ \*\*  
 \* Rated data  
 \*\*ErP 2013

## Characteristic curve

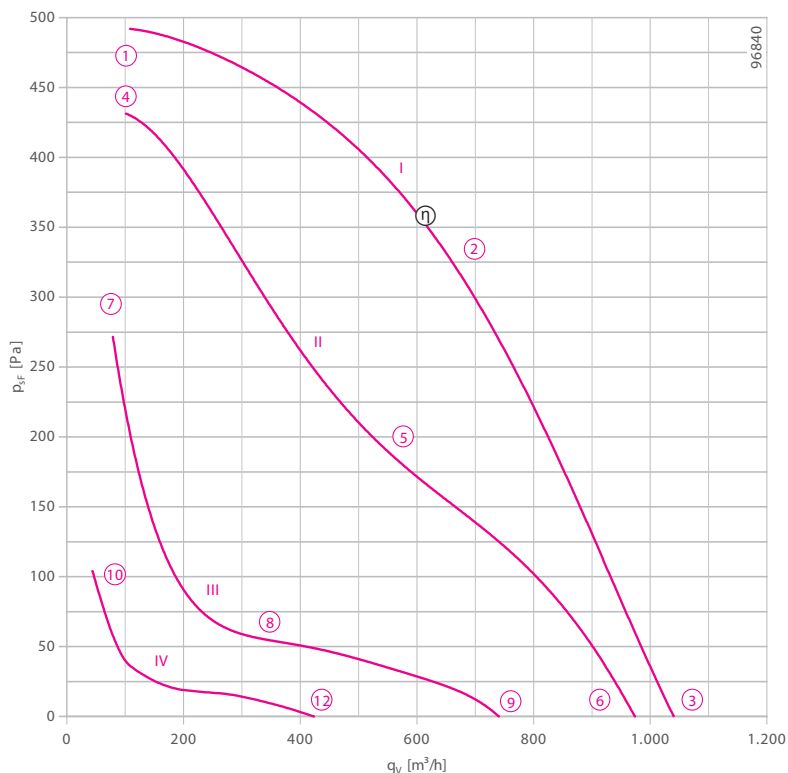

measured with inlet ring, without guard grille according to ISO 5801

- Inlet ring 00278352 Page 451
- Connection diagram 1360-126XA Page 550
- System components Page 448

## Dimensions [mm]

Free-running motor impeller RH  
in installation position H/Vu/Vo

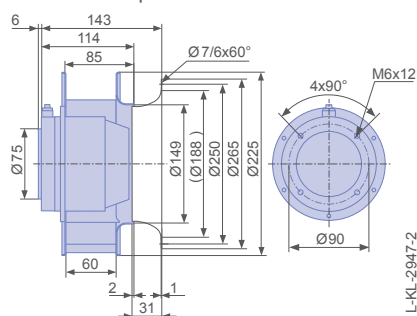

Performance data

| Type            | Characteristic curve | Voltage | Operating point | Current | Motor input power  | Speed                  | Suction side sound power level |
|-----------------|----------------------|---------|-----------------|---------|--------------------|------------------------|--------------------------------|
|                 |                      | U [V]   |                 | I [A]   | P <sub>1</sub> [W] | n [min <sup>-1</sup> ] | L <sub>WA5</sub> [dB]          |
| RH22M-2EK.1B.2R | I                    | 230     | ①               | 0.48    | 110                | 2860                   | 74                             |
|                 |                      | 230*    | ②               | 0.68*   | 160*               | 2750*                  | 69                             |
|                 |                      | 230     | ③               | 0.48    | 110                | 2860                   | 77                             |
|                 | II                   | 170     | ④               | 0.58    | 100                | 2690                   | 72                             |
|                 |                      | 170     | ⑤               | 0.92    | 150                | 2170                   | 63                             |
|                 |                      | 170     | ⑥               | 0.60    | 100                | 2680                   | 76                             |
|                 | III                  | 135     | ⑦               | 0.72    | 95                 | 2160                   | 66                             |
|                 |                      | 135     | ⑧               | 0.88    | 120                | 1220                   | 52                             |
|                 |                      | 135     | ⑨               | 0.78    | 100                | 2040                   | 69                             |
|                 | IV                   | 110     | ⑩               | 0.72    | 75                 | 1340                   | 53                             |
|                 |                      | 110     | ⑪               | 0.72    | 75                 | 1170                   | 58                             |

\*rated data

Fan ordering information

Design RH\*

Installation position H/Vu/Vo





Electrical connection Supply cable lateral 105cm



**Type** RH22M-2EK.1B.2R  
**Article no.** 161861

Weight [kg] 3.20  
\* Inlet ring not included

Control technology

|   |  |   |   |
|---|--|---|---|
| <p>Frequency inverter<br/>Fcontrol 1~</p>  <p>➤ Page 478</p> | <p>Motor protection units<br/>1~</p>  <p>➤ Page 526</p> | <p>Transformer-based<br/>controllers 1~</p>  <p>➤ Page 517</p> | <p>Electronic voltage<br/>controllers 1~</p>  <p>➤ Page 492</p> |
|---|--|---|---|